

Room temperature

TM-2100

Room command module

The TM-2100 series of room command modules are designed for use with the FCC and Facility Explorer series of DDC terminal unit controllers. The setpoint dial enables the room occupant to adjust the working set point of the controller within the range of 12...28 °C or -3...+3°, according to the model number.

The occupancy button enables the occupant to switch the mode of operation of the controller between COMFORT and STANDBY or to request a temporary COMFORT mode during NIGHT operation.

A LED indicator shows the current operating mode.

A Room Command Module with a 3-speed fan override adjuster is available.



Features

- ▶ Passive sensor
- ▶ NTC 10K temperature output
- ▶ Remote temperature setpoint adjustment
- ▶ 3-speed fan override
- ▶ Occupancy override button
- ▶ Room enclosures 80 x 80 mm
- ▶ Protection class: IP30

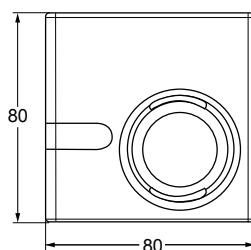

TM-2140-0000

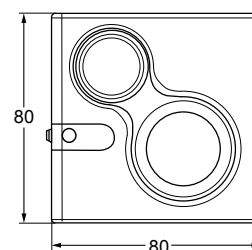
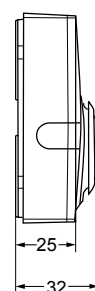

TM-2160-0007 and TM-2170-0007

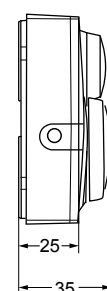

Dimensions in mm

Ordering information

Codes	Built-in sensing element	Temperature setpoint dial scale	Fan speed override	Occupancy button
TM-2140-0000	NTC 10K	---	---	---
TM-2150-0000		---		---
TM-2160-0000		12-28 °C	3-speed fan override	•
TM-2160-0005		+/-		
TM-2160-0002		12-28 °C		
TM-2160-0007		+/-		
TM-2190-0000		12-28 °C	---	---
TM-2190-0005		+/-		

Accessories (order separately)

Codes	Description
TM-1100-8931	Plastic base for surface mount
TE-9100-8502	Unit mount NTC K10 temperature sensor (1.5 m cable)
TM-9100-8900	Special tool for opening enclosure